



4 Salamanca Place, London
SE1

GARTONJONES.COM



4 Salamanca Place, London , SE1

£650 Per Week

A fantastic 2 bedroom apartment of 685sq.ft (64sq.m) available to rent in Salamanca Tower, a modern residential development just moments from the banks of the River Thames. The well-proportioned property offers stylish living presented in good condition with a spacious dual aspect open plan, south facing reception room flooded with natural light with an integrated modern kitchen, a balcony with far reaching views, generous double bedrooms, both with wardrobes and a modern bathroom suite.

4 Salamanca Place is a secure development with residents benefitting from a private roof terrace offering stunning views of the Houses of Parliament. The building also benefits from being moments from London's trendy South Bank and a great selection of shops, bars and restaurants. Transport links include Vauxhall Underground Station (Victoria Line) for links into the City and West End.

Please note furniture may differ to that shown in the current photos.

- 2 Bedrooms
- 685sq.ft (64sq.m)
- 1 Bathroom
- Open Plan Reception Room
- Modern Kitchen
- Balcony
- South Facing
- Secure Entry
- Residents Roof Terrace
- 0.6 Miles to Vauxhall Station

GARTON JONES.COM

9 Albert
Embankment
London
SE1 7SP

Lettings:
+44 (0) 20 7735 1888
nineelms@gartonjones.com
www.gartonjones.com



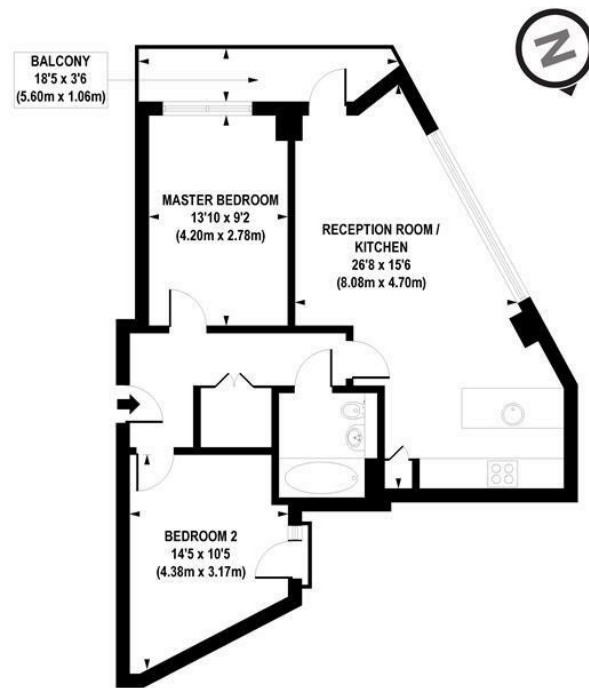

APPROX. GROSS INTERNAL FLOOR AREA 702 sq. ft / 65.22 sq. m

Floorplan is for illustrative purposes only and is not to scale.
Every attempt has been made to ensure the accuracy of the floorplan shown, however all measurements, fixtures, fittings and data shown are an approximate interpretation for illustrative purposes only.
Liability for errors, omissions or mis-statement through negligence or otherwise is hereby excluded.

CPCREATIVE
PROPERTY MARKETING

